

## Case Study - Quays Hope Island

### PARTIWALL® SOLUTION FOR SUNLAND HOMES

A leading residential development group on Queensland's Gold Coast has discovered the benefits of USG Boral Partiwall® System for multi-residential complexes.

Sunland Group is a development company that operates in both the housing and high rise division, building about 600 to 700 homes a year. Founded on Queensland's Gold Coast in 1983, it was Publicly listed in 1995 and has offices in Sydney, Melbourne and the Gold Coast in addition to its Brisbane headquarters.

At the heart of Sunland's enduring commitment to creating 'architecture as art' is its vision to build vibrant communities and, in turn, shape a sustainable future. Its design philosophy and values work hand in hand to engage, transform and define the experience of 'community' for future generations.

About nine years ago Sunland started looking for a company to provide fire-rated party walls that could meet its requirements. USG Boral Partiwall® System fulfilled a lot of criteria it looked for – especially the technical criteria. It now forms part of Sunland's construction methodology and they are very happy with it.

As Riaz Rezvani, Housing Manager for Sunland Group says, "It saves us time, it saves us money and it gives us a product that we can rely on."



**RIAZ REZVANI, HOUSING MANAGER,  
SUNLAND GROUP**

What I would say to other people considering using this [USG Boral Partiwall®] system is that the benefit includes both time and money. It's much faster and it saves you money because you eliminate other trades.



<b>Project</b>	Quays residential development
<b>Location</b>	Hope Island, QLD
<b>Builder</b>	Sunland Group
<b>Year</b>	2015
<b>Product</b>	Partiwall® separating wall system
<b>Scope</b>	40 townhouse development

**To watch as a video case study:**



1. DOWNLOAD THE FREE LAYAR APP



2. SCAN THIS PAGE



3. WATCH THE VIDEO!

## QUAYS HOPE ISLAND

One Sunland Group project that used the USG Boral Partiwall® system was Quays Hope Island – a premium collection of 40 townhouses surrounding central parkland. Nestled into lush, green surroundings within the established environs of Hope Island, each three-bedroom residence is generously proportioned for contemporary open plan living. North-east orientation naturally captures the light and warmth with large windows, alfresco entertaining areas and beautifully landscaped gardens.



### JOE FINICCHIARO, CONSTRUCTION MANAGER SUNLAND HOMES

... [USG Boral Partiwall® is] light, it's very quick to put up, they don't have to leave site, they can just continue on building, there's no time loss - it's just so easy.



Riaz Rezvani points to the value of the relationship Sunland Group has built with USG Boral.

“We do use a lot of companies, but USG Boral really understand us. The way we operate is like a partnership. Through their representative, they're always there, and if you need any technical advice, they always send somebody or the representative comes to our site and can provide us with technical knowledge or installation processes. This is quite important for us because we are confident in the way we install it and any technical issue is resolved straight away.”

### MORE INFORMATION

For more information on USG Boral Partiwall® systems please call TecASSIST™ on **1800 811 222** or visit **[USGBoral.com/au/partiwall](http://USGBoral.com/au/partiwall)**

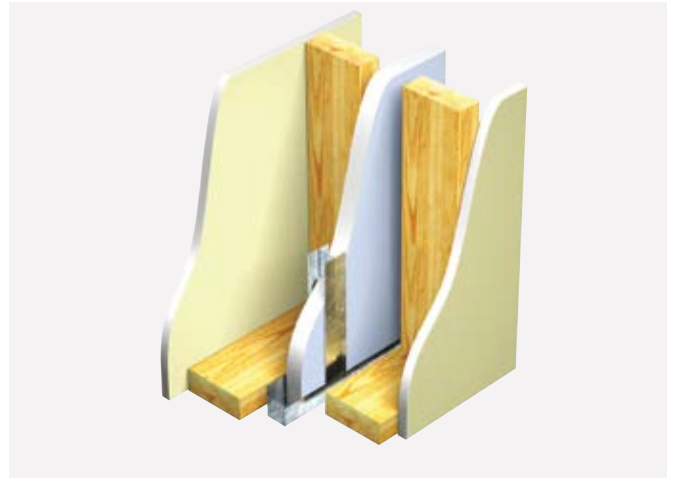

SALES ENQUIRIES **1800 226 215** (AU)

**0800 USGBORAL** (NZ)

© 2017 USG BORAL. All rights reserved. The trademarks USG Boral, INNOVATION INSPIRED BY YOU, TecASSIST and Partiwall are trademarks of USG Boral Building Products or one or more of its affiliates. The opinions expressed by employees of Sunland Group above are their opinions and should not be taken to reflect the views or opinions of USG Boral. USG Boral Building Products Pty Limited - ABN 84 004 231 976 - 251 Salmon Street, Port Melbourne, Vic 3207