

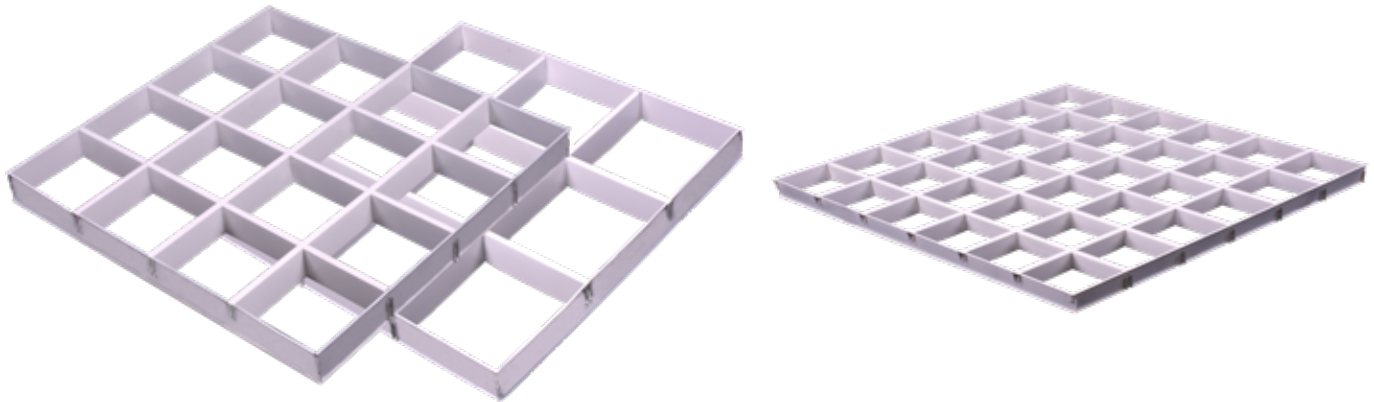

Open Cell Ceiling Systems



The USG Boral open cell ceiling system creates a simple open plan ceiling design. These panels can be easily installed or removed, providing quick access to the ceiling plenum.

FEATURES AND BENEFITS

- An open plan ceiling design with modular cell element provides a unique seamless look to any indoor space
- Each unit made up of aluminium alloy strip blends in with main runners and cross runners
- Easily installed and removable cell elements provides easy access to plenum above
- Multiple cell element height options available
- A wide range of colors to achieve a customised effect
- Individually replaceable cell elements

APPLICATIONS

- Entertainment venues
- Galleries
- Lounges
- Foyers
- Corridors
- Commercial spaces

MATERIAL OPTIONS

- Galvanised Mild Steel
- Aluminium

COMPONENT DRAWING

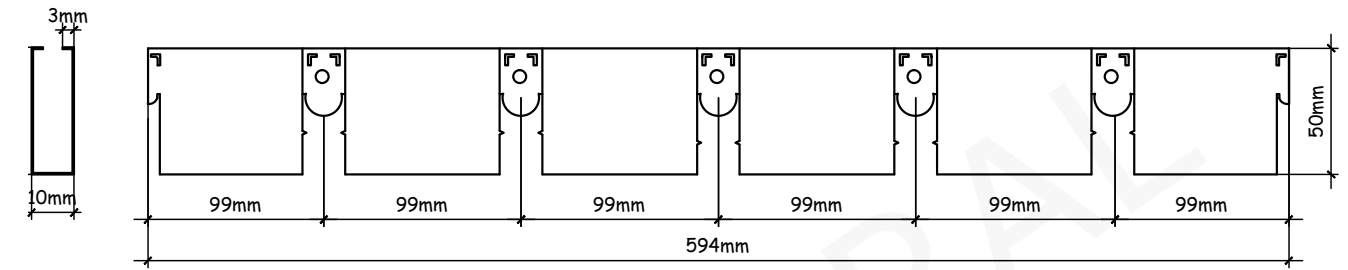

Sample Main Runner profile

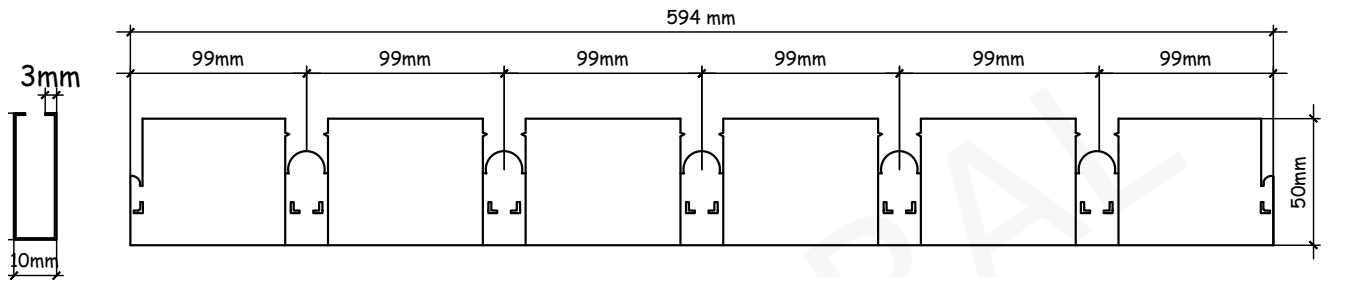

Sample Cross Runner profile

PATTERNS

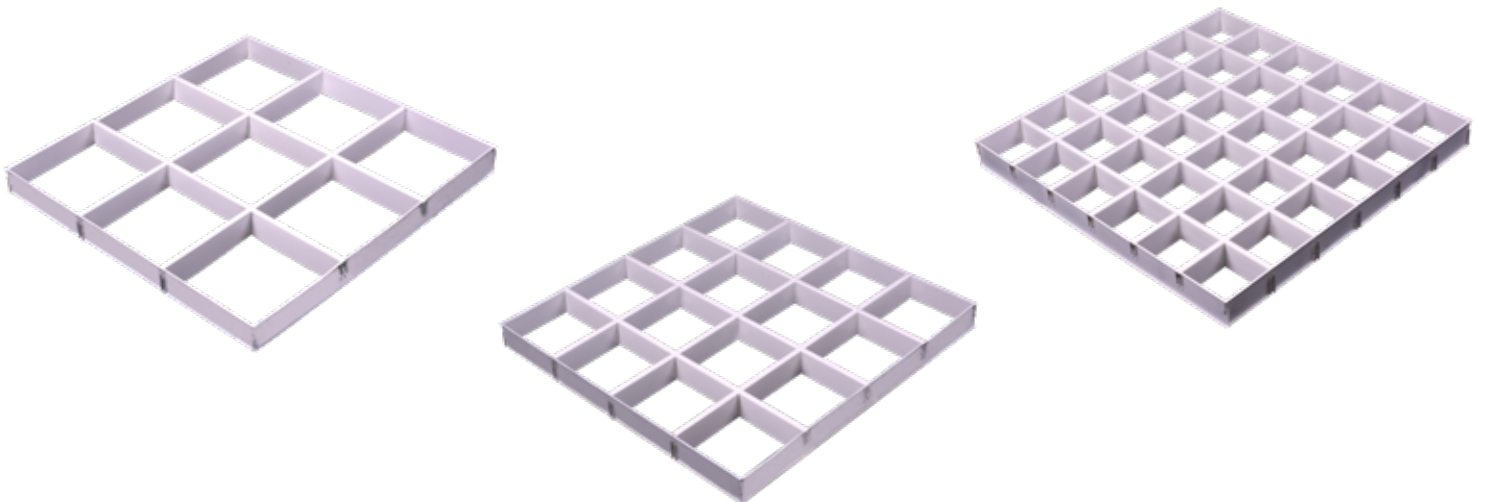

GENERAL ARRANGEMENT DRAWING OF SUSPENSION SYSTEM

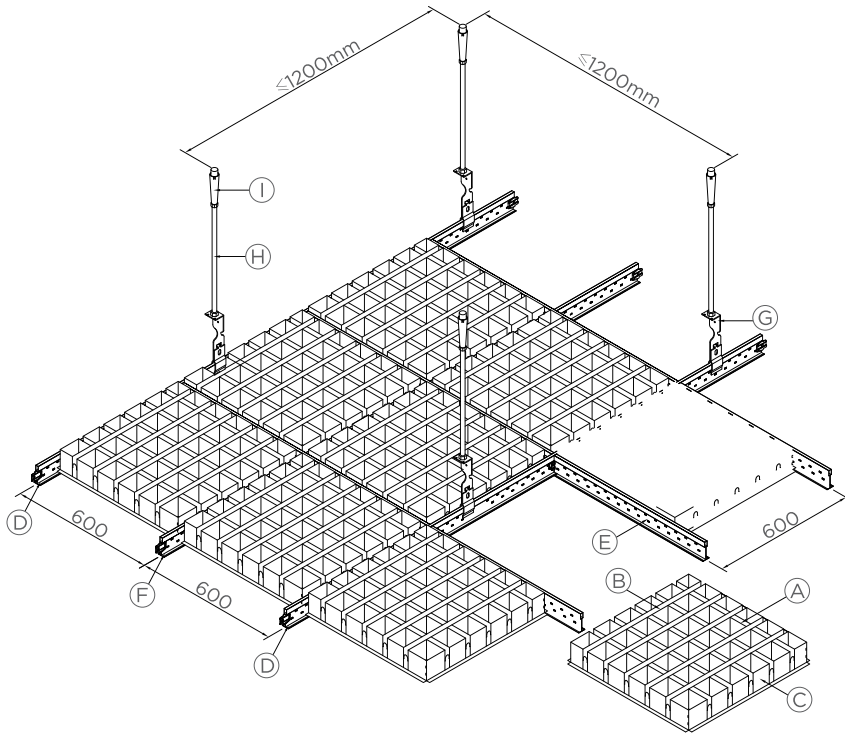

Item	Description
A	Cell element A
B	Cell element B
C	Cell element D
D	Main runner
E	Cross runner
F	Cross runner (0.6m)
G	Runner bracket
H	Threaded rod
I	Anchor bolt

SPECIFICATIONS

Open Cell Tiles

Material	Thickness	Pattern	Panel Size	Grid options	Coating
GI	0.5	75X75	600x600	T15	Prepainted
GI	0.5	100x100	600x600	T15	Prepainted
GI	0.5	150x150	600x600	T15	Prepainted
GI	0.5	200x200	600x600	T15	Prepainted
Aluminium	0.7	75X75	600x600	T15	Powder Coated
Aluminium	0.7	100x100	600x600	T15	Powder Coated
Aluminium	0.7	150x150	600x600	T15	Powder Coated
Aluminium	0.7	200x200	600x600	T15	Powder Coated

COLOUR OPTIONS



WHITE



BLACK